

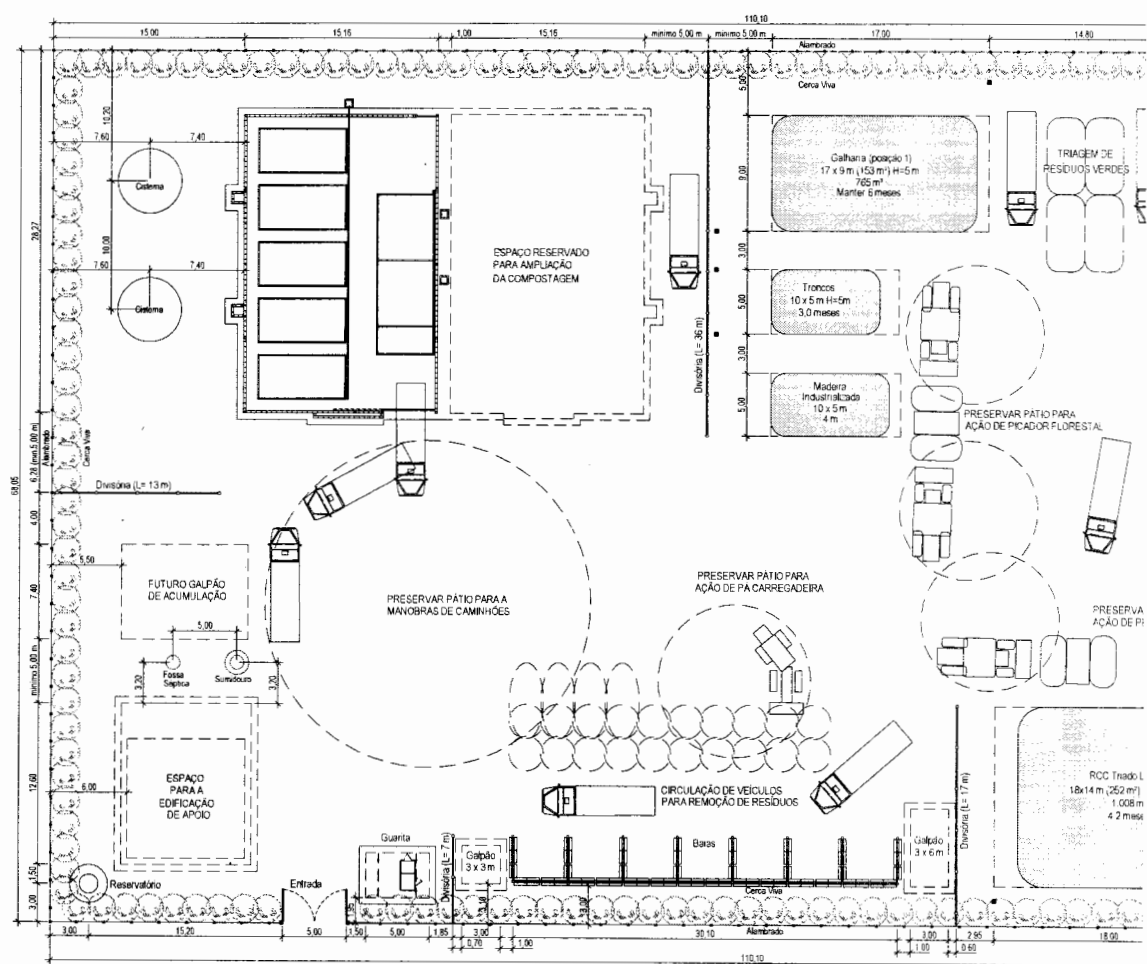

**DESENHOS GERAIS**

**E DETALHES**



**IMPLANTAÇÃO**  
 Esc 1:200

**NOTA:**  
 AS MEDIDAS INDICADAS ENTRE OS ELEMENTOS SÃO PARÂMETROS DE REFERÊNCIA PARA ADAPTAÇÃO AOS TERRENOS OFERTADOS NOS MUNICÍPIOS.

*[Handwritten signature]*

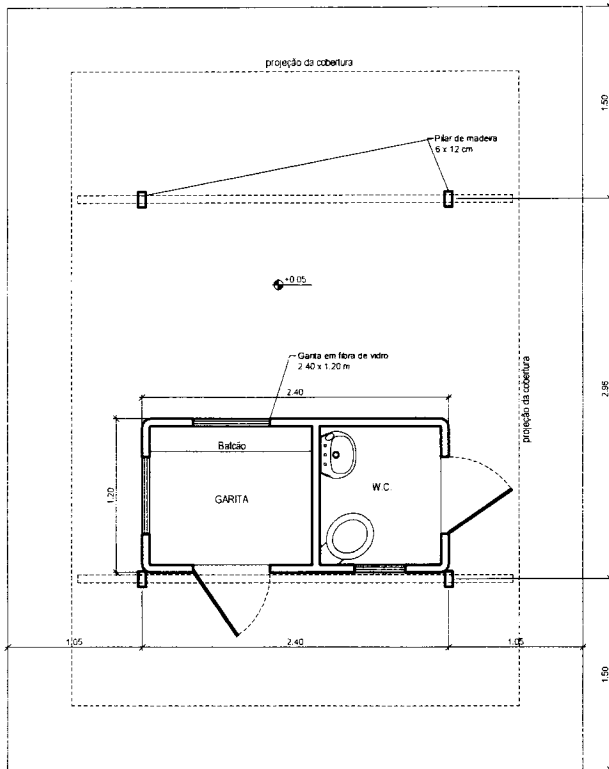

PLANTA  
 ESC. 1/20

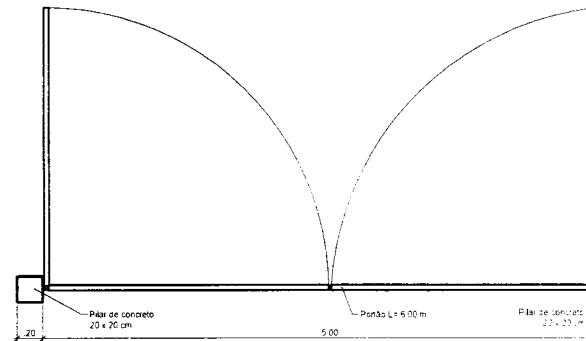

PORTÃO - PLANTA  
 ESC. 1/20

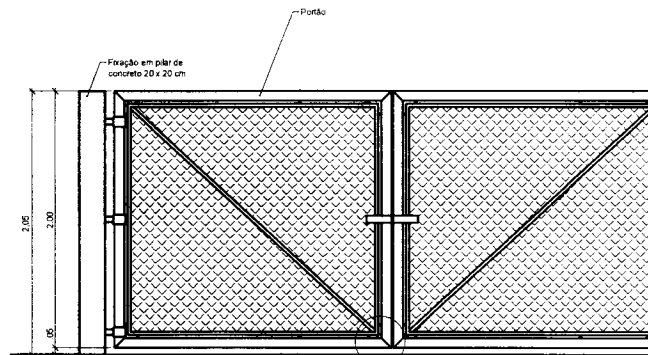

PORTÃO - VISTA FRONTAL  
 ESC. 1/20

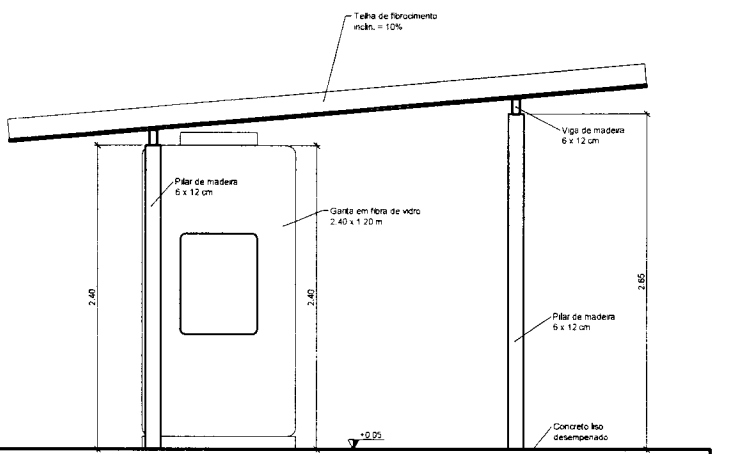

VISTA 1  
 ESC. 1/20

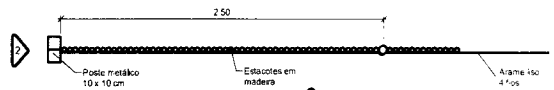

PLANTA - CERCA DE ESTACOTE  
 ESC. 1/20

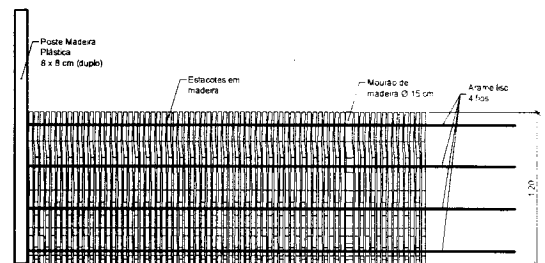

VISTA 1 - CERCA DE ESTACOTE  
 ESC. 1/20

[Assinatura]

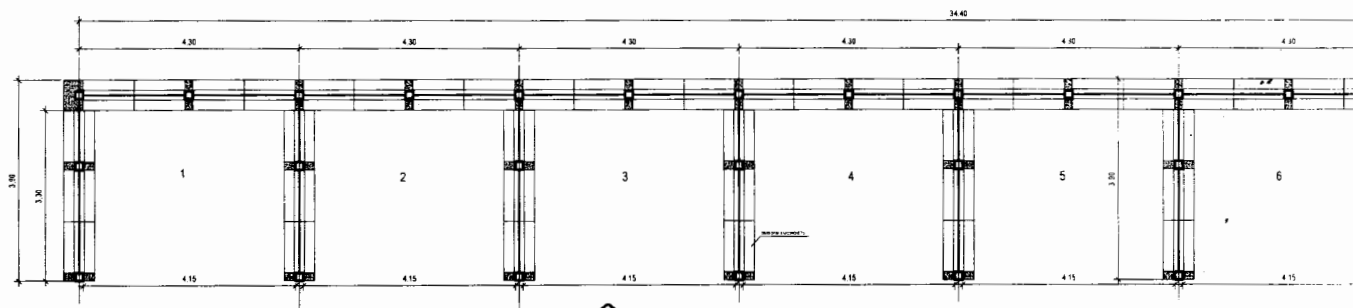

PLANTA

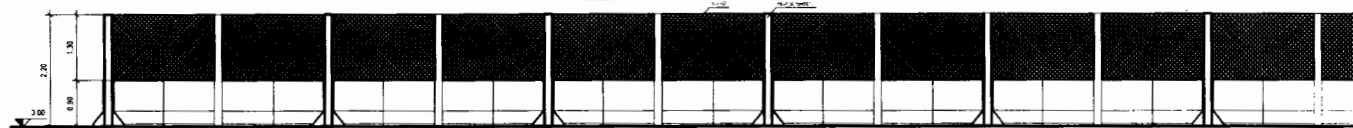

VISTA 1



PERSPECTIVA

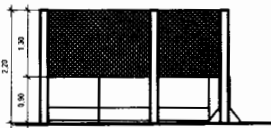

VISTA 2

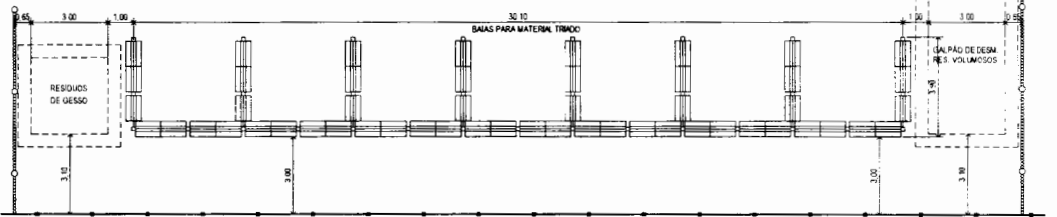

LOCAÇÃO INSTALAÇÕES DA TRIAGEM

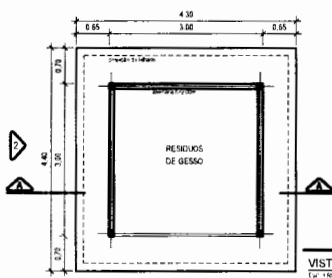

PLANTA

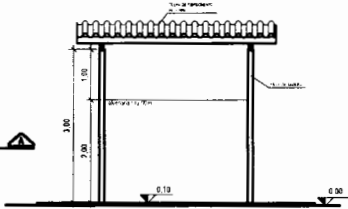

VISTA 1

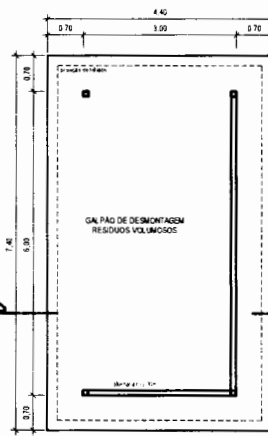

PLANTA

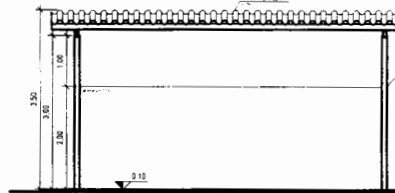

VISTA 1

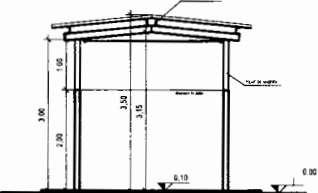

VISTA 2

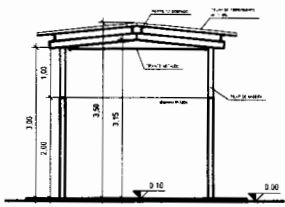

CORTE AA

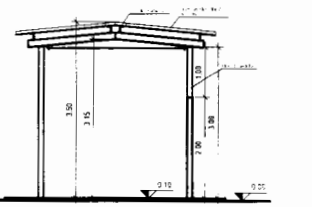

CORTE BB

*[Handwritten signature]*

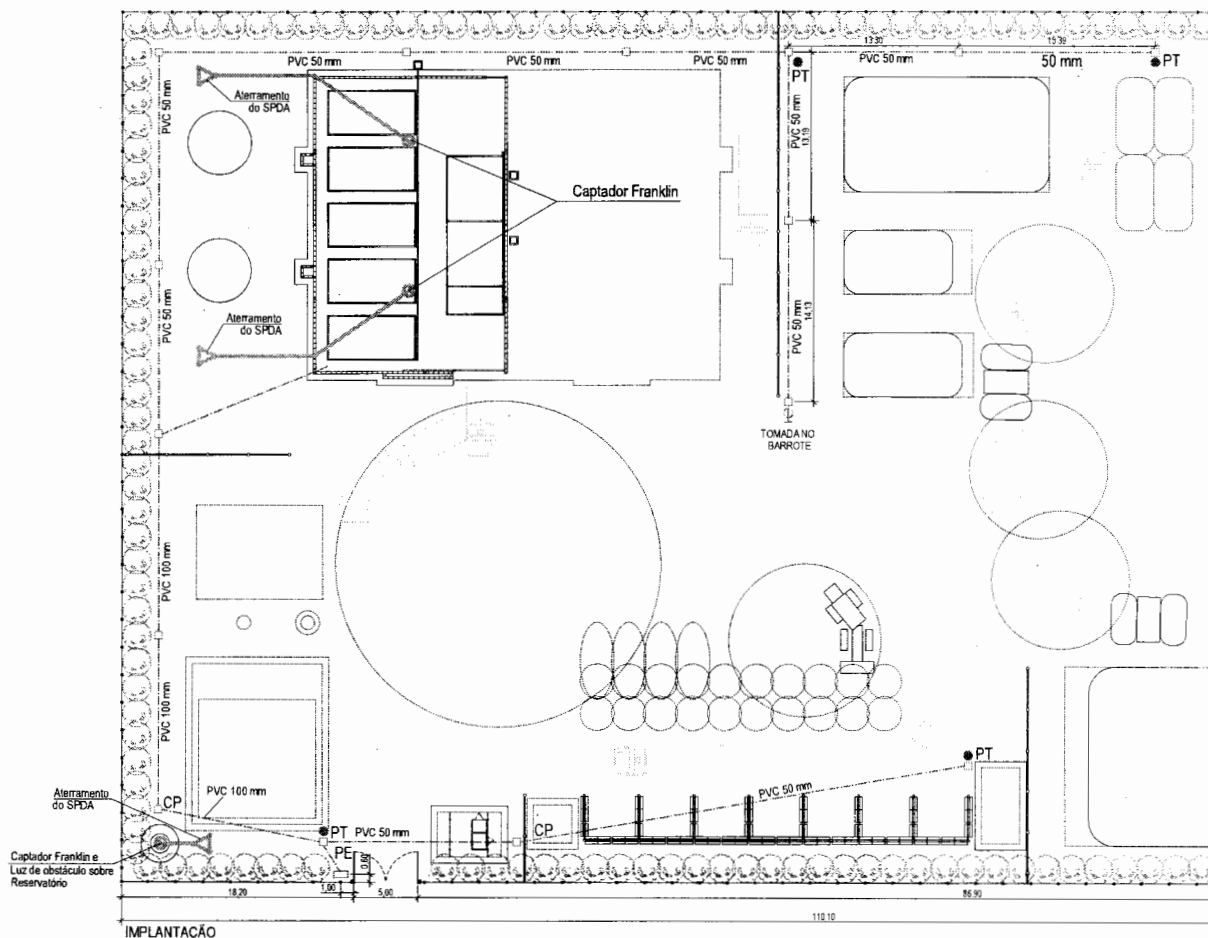

IMPLANTAÇÃO  
 ESC. 1:200

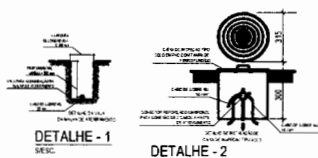

SISTEMA DE PROTEÇÃO CONTRA DESCARGAS ATMOSFÉRICAS  
 CAPIM PRIMEIRO DE DIMENSÕES BARROTE  
 TUBO CILÍNDRICO SALVAMANTO A FOGO 38x6 DE ALUMÍNIO  
 CABELO DE CORDÃO 1/2\"/>

**NOTA**  
 O SISTEMA DE PROTEÇÃO CONTRA DESCARGAS ATMOSFÉRICAS DEBEM SER REALIZADO POR ENGENHEIRO ELÉTRICO ESPECIALIZADO JUNTO A CONCESSIONÁRIA DE ENERGIA ELÉTRICA ASSUMINDO A RESPONSABILIDADE TÉCNICA

- NOTAS:**
- As caixas de passagem (CP) deverão estar distancadas no máximo 50 m
  - As medidas indicadas entre os elementos são parâmetros de referência para adaptações aos terrenos ofertados nos municípios;
  - Este projeto é composto de folhas de desenho e memorial descritivo.
  - É imprescindível a consulta do memorial descritivo.

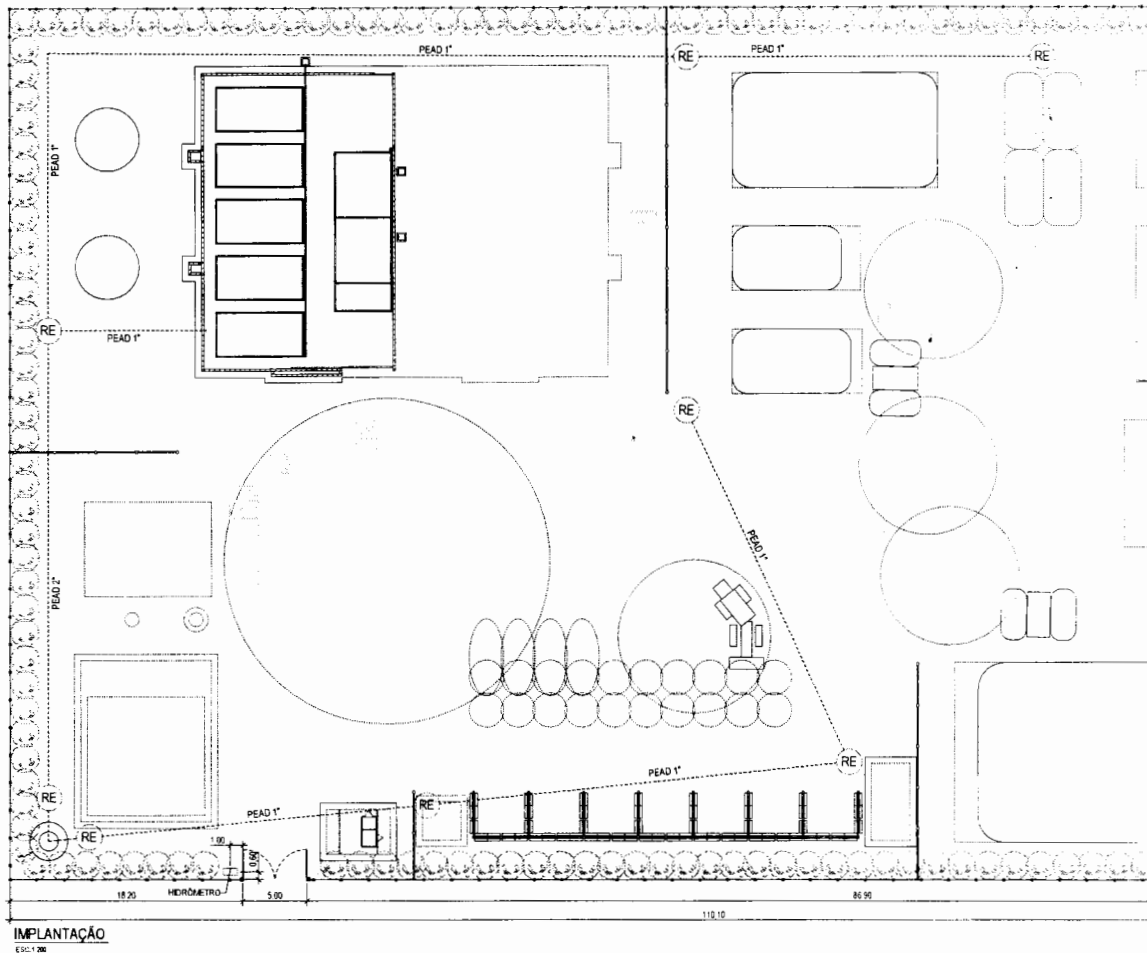

**LEGENDA:**  
 RE - Registro de gaveta

**NOTAS:**  
 - Os registros de gaveta deverão estar distanciadas no máximo 60 m  
 - As medidas indicadas entre os elementos são parâmetros de referência para adaptações aos terrenos ofertados nos municípios

*[Handwritten signature]*

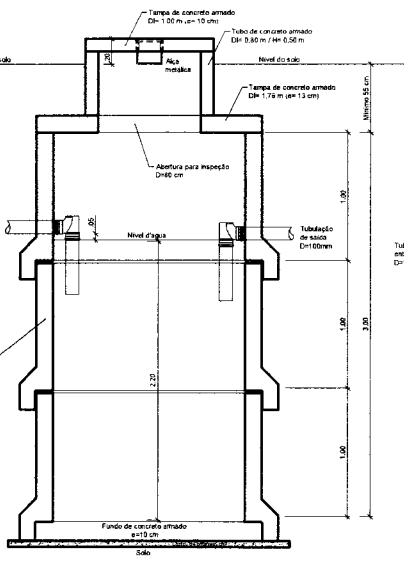

**FOSSA SÉPTICA - CORTE**  
ESC: 1/20

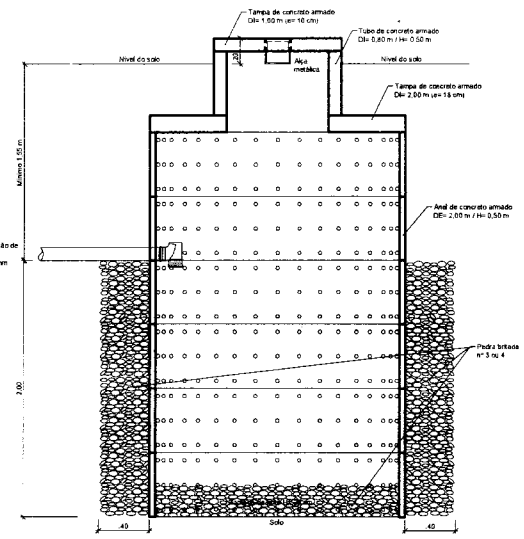

**SUMIDOURO - CORTE**  
ESC: 1/20

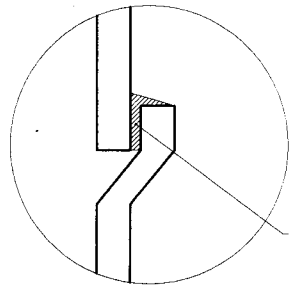

**DETALHE DO ENCAIXE**  
ESC: 1/10

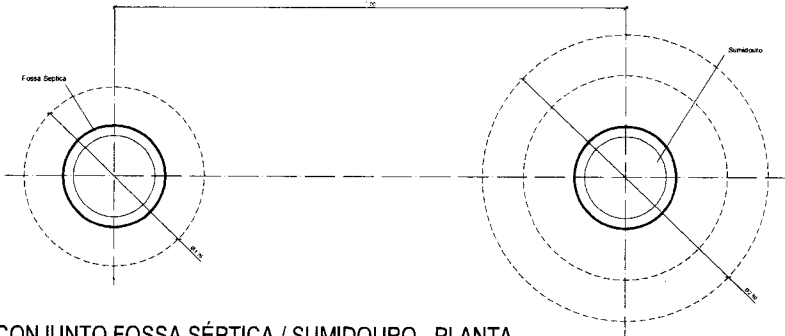

**CONJUNTO FOSSA SÉPTICA / SUMIDOURO - PLANTA**  
ESC: 1/25

**NOTA**  
EM SITUAÇÕES COM IMPOSSIBILIDADE DE ESCAVAÇÃO, O SISTEMA DE DESTINAÇÃO DO ESGOTO COLETADO PODERÁ SER ALTERADO PARA OUTRA SOLUÇÃO ADEQUADA.

*Handwritten signature*

